

CLIENTS (SELECTION)

Adina Apartment Hotels • Ackermans & Van Haaren • AENA (Spanish Airports Authority) • AG Real Estate • Alfa Wassermann • Astana Airport • Altarea Cogedim • Banca Popolare di Milano • Banimmo • BAUWERT Investment Group GmbH & Co.KG • BBC Worldwide • Beni Stabili Siiq • Bouygues • Bouwfonds Investment Management • Bundesamt für Bauwesen und Raumordnung • Canary Wharf Group • Cisco Systems • Credit Agricole Immobilier • Credit Suisse • Dassault Systemes • Deutsche Bank • DHL • Dubai World Trade Centre • ECE • Equilis • Eiffage Immobilier • Eni • Ferrovial • Greenland • Groupe Accor • Gutman Investment GmbH • HCA (Hospital Corporation of America) • Heinz • Hewlett Packard • Icade • IKEA Verwaltungs-GmbH • Immobilière Guido Eckelmans • Immochan • ING Bank n.v. • John Deere • Kellogg Italia • Leaseplan • Lend Lease • Lexmark • L'Oreal • Lufthansa Group • Maire Tecnimont • Marks & Spencer • MIRAX Group • Munich Re Group • OHL • Olav Thon Gruppen • Palace of Westminster • PPL (Polish Airports Authority) • Real Madrid C.F. • Roca • Santander Bank • Sefri Cime • Skanska • Sogelym Steiner • Ten Brinke • THE BLACKSTONE GROUP • UnipolSai • Vinci Immobilier • Vivico Real Estate GmbH • VTB OAO Bank • Volkswohl Bund Lebensversicherungen AG • Wanda Group • West SA (Besix Group) • Willemen Group

CONTACT

Altiplan° Architects
Brussels, Liège
info@altiplan.eu
www.altiplan.eu

Arte Charpentier Architectes
Paris, Lyon
contact@arte-charpentier.com
www.arte-charpentier.com

Estudio Lamela
Madrid
lamela@lamela.com
www.lamela.com
Warsaw
warszawa@lamela.com
www.lamelapolska.com

HOK
London
london@hok.com
www.hok.com

Progetto CMR
Milan, Rome, Athens, Istanbul
pcmr@progettocmr.com
www.progettocmr.com

TCHOBAN VOSS Architekten
Hamburg, Berlin, Dresden
EAN@tchobanvoss.de
www.tchobanvoss.de

SECTORS

OFFICE

CORPORATE

RESIDENTIAL

RETAIL

AVIATION

TRANSPORTATION

SPORT + LEISURE

ENTERTAINMENT

MIXED USE

HOSPITALITY

HEALTH + CARE

CIVIC + CULTURAL

RESEARCH + EDUCATION

GOVERNMENT

CONSERVATION

MASTER PLANNING

CONSULTING

LANDSCAPING

INTERIOR DESIGN



European Architects Network

The world continues to be a rapidly changing-place. Our clients and collaborators are faced with fierce competition in their own markets as they respond to economic and political change; the European Union continues to flourish and expand eastwards increasing the prosperity of many whilst China and India bestow many opportunities for those of us willing to participate and invest.

The success of the European Architects Network (EAN) in the last years has been underpinned by our understanding of local markets along with the bringing-together of international specialists to work on projects in the major capital cities of Europe. More recently, as a network, we have started to collaborate to find solutions to sustainable design. We're aware that as designers we need to help reduce carbon emissions and limit the damaging effects of climate change.

The EAN has extensive design experience across many sectors, including sustainable design, with 12 offices offering a range of diverse services including: master planning; mixed use; hospitality; retail; offices; interiors; transportation; sports architecture; conservation and strategic consulting services.

The EAN is **unique in Europe** and demonstrates a capability to deliver design innovation, expertise and knowledge in a truly collaborative and seamless way.



Who?



The EAN is a flexible association of architects, delivering excellent architecture with innovative and sustainable design across Europe.

Why?



The EAN serves clients who want to undertake projects in countries across Europe, offering a local presence with access to global expertise.

What?



The Network has extensive design experience across many sectors, offering a range of diverse services including master planning, mixed use, hospitality, retail, offices, interiors and product design, transportation, sports architecture, conservation and strategic consulting services.

Where?



The EAN has 12 offices in cities throughout Europe. Our knowledge of local market variations and national planning and building laws offers the appeal of working with well-established European practices.

How?



By assembling teams drawn from the Network practices, EAN is able to offer unparalleled access to experts with experience of building types in every sector. Unlike the regional outposts offered by competitors, each office is an integral part of a European and global network.



Altiplan° Architects Belgium

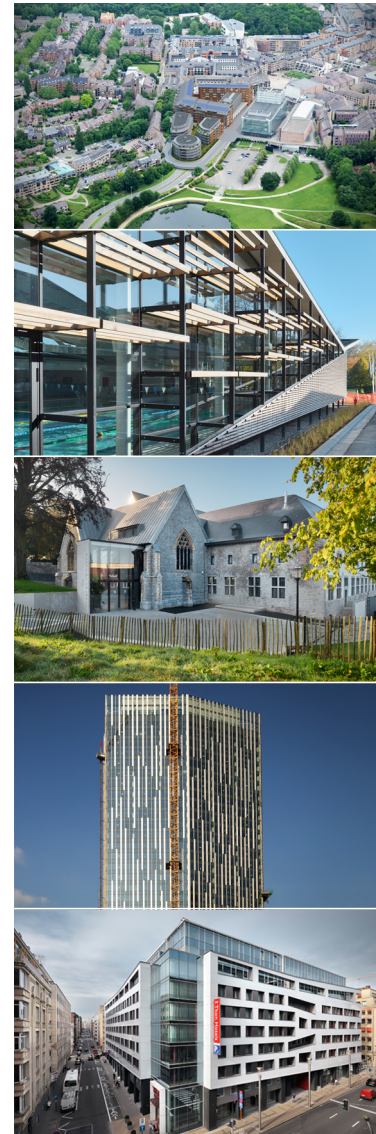

Arte Charpentier Architectes France



Estudio Lamela Spain, Poland



HOK United Kingdom

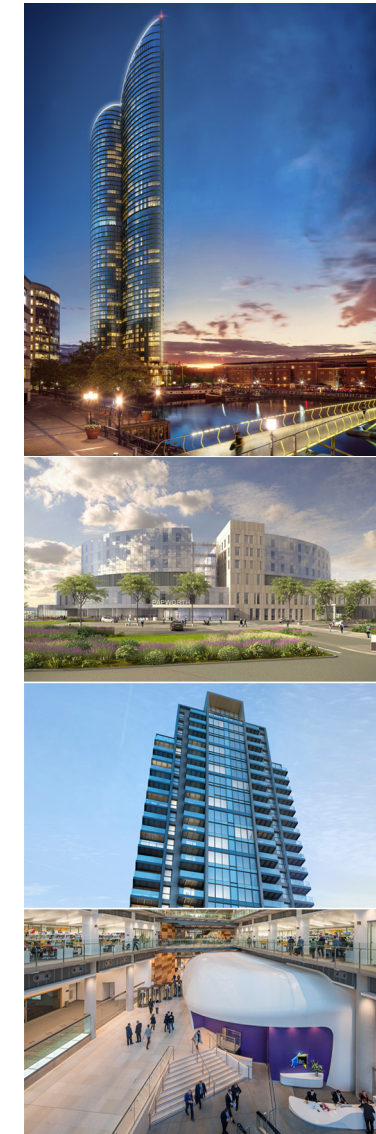

Progetto CMR Italy, Turkey, Greece



TCHOBAN VOSS Architekten Germany

